



Expertise to rely on



Double Skin Plenum

The Double Skin Modular Plenum Box is installed after the AHUs for Discharge of Air to the Ducts of the HVAC Air distribution system with low pressure drop and decreasing the noise levels. The construction of Plenum ensures proper air distribution to the HVAC duct system.

PLENUM CONSTRUCTION

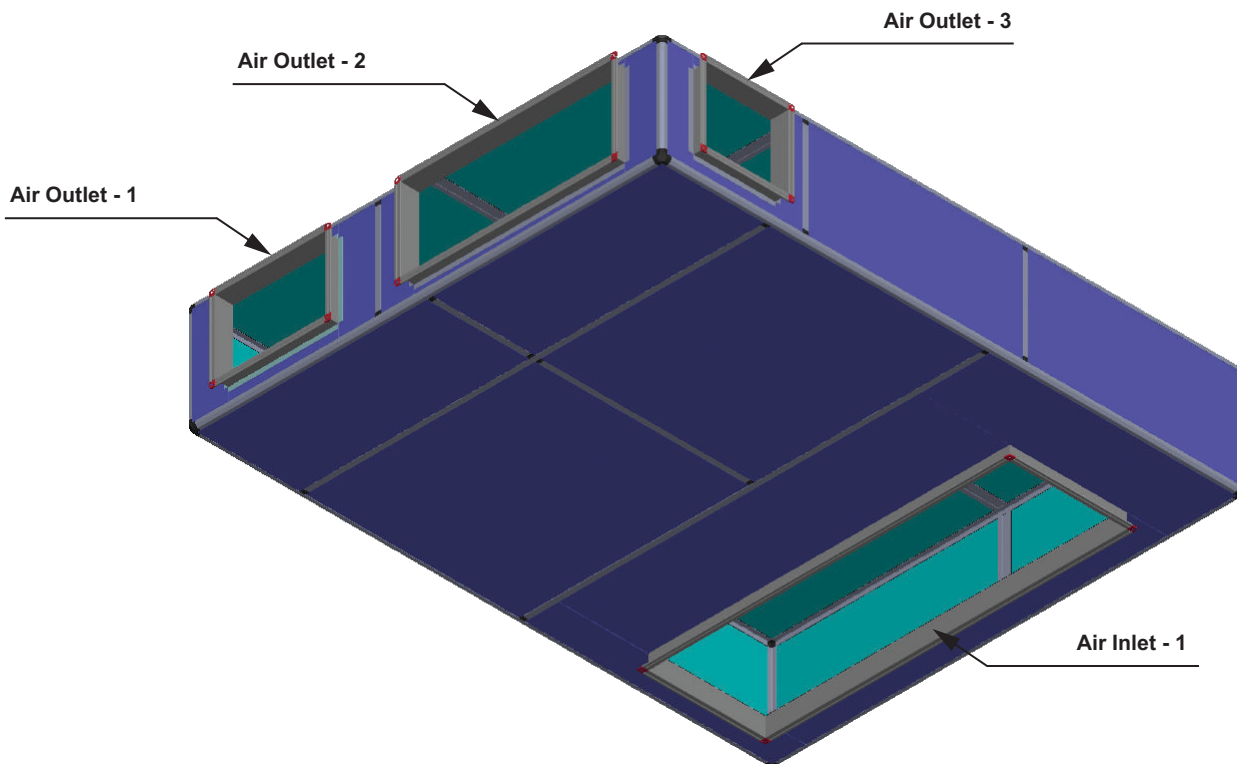

The Plenum is constructed with extruded Aluminium sections to form rigid frame and walls made of double skin construction with Polyurethane (PU) Foam filling to provide Insulation effect. The Plenum construction ensures that it significantly reduces the sound levels from the AHU.

The Plenum has factory fabricated TDF flanges at the Inlet & Outlet Connections which ensures seamless and easy connection with AHU Outlets, Dampers and Ducts respectively.

The Plenum construction is maintenance friendly through easy access to all components. The panels may be removed from all sections without compromising the Plenum rigidity which is ensured by the aluminium frame.

Module to module assembly shall be accomplished with a specially designed jointer Aluminium profile that is sealed with gasket on both mating modules to meet indoor air quality standards.

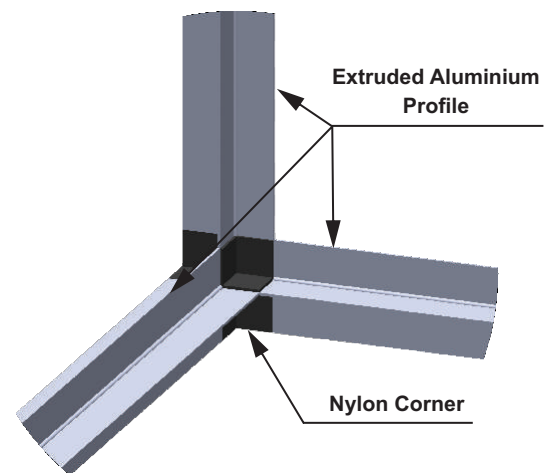

Aluminum frame assembly with Nylon Corner

PLENUM FRAME

- The extruded Aluminium profile is joined with Nylon corner piece as per the modular design, thus forming the rigid frame of the Plenum.
- The double skin PU insulation panel is fixed to the Aluminium frame with high quality rivets with Gasket placed for Solid Air tight fixing.

BODY PANEL

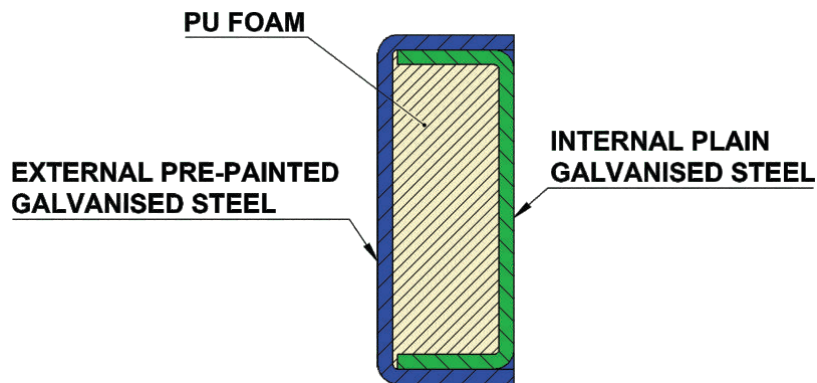

The Plenum wall is made up by Double Skin Polyurethane Foam (PU) insulation panel with high strength pre-painted Galvanized Steel as external casing and Plain Galvanized Steel as internal casing.

Panel thickness	25mm (+/- 2mm) or 45 mm(+/- 2mm)
Insulation Density	40 kg/m ³
Thermal conductivity	0.017 W/ M°K

INLET / OUTLET CONNECTION

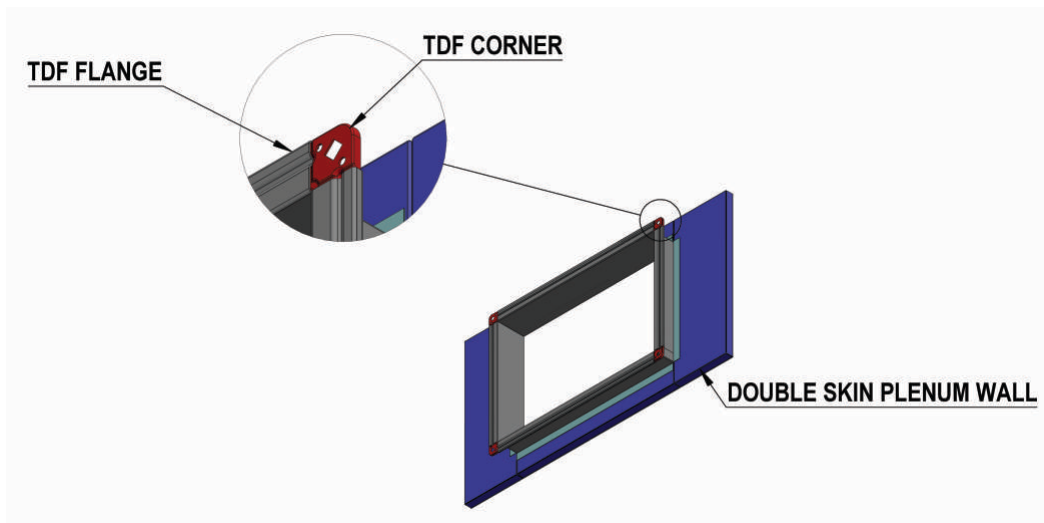

The Inlet & Outlet connections of the Plenum are with factory fabricated TDF flange. The flange ends are assembled with TDF corner pieces with square slot for carriage bolt fixing and connectivity with ducts and flange with TDF cleats for maximum leak protection.

* **Access door** can be supplied on customer requirement, constructed as a hinged access door with removable panel with handles and panel block. Gasket around the full perimeter of the access doors frame to be used to prevent air leakage.

FEATURES

- The Plenum design is based on the **Modular concept**, which can be disassembled while shipping and can be easily reassembled at site for easy transportation and to save the logistics cost.
- **The Inlet & Outlet Connections with TDF flange** is an exclusive feature to VEDHA make Double Skin Plenums, which would ensure hassle-free & Leak proof connection with mating Ducts.
- **Access door** provided on customer requirement for easy ingress and maintenance.

NOMENCLATURE

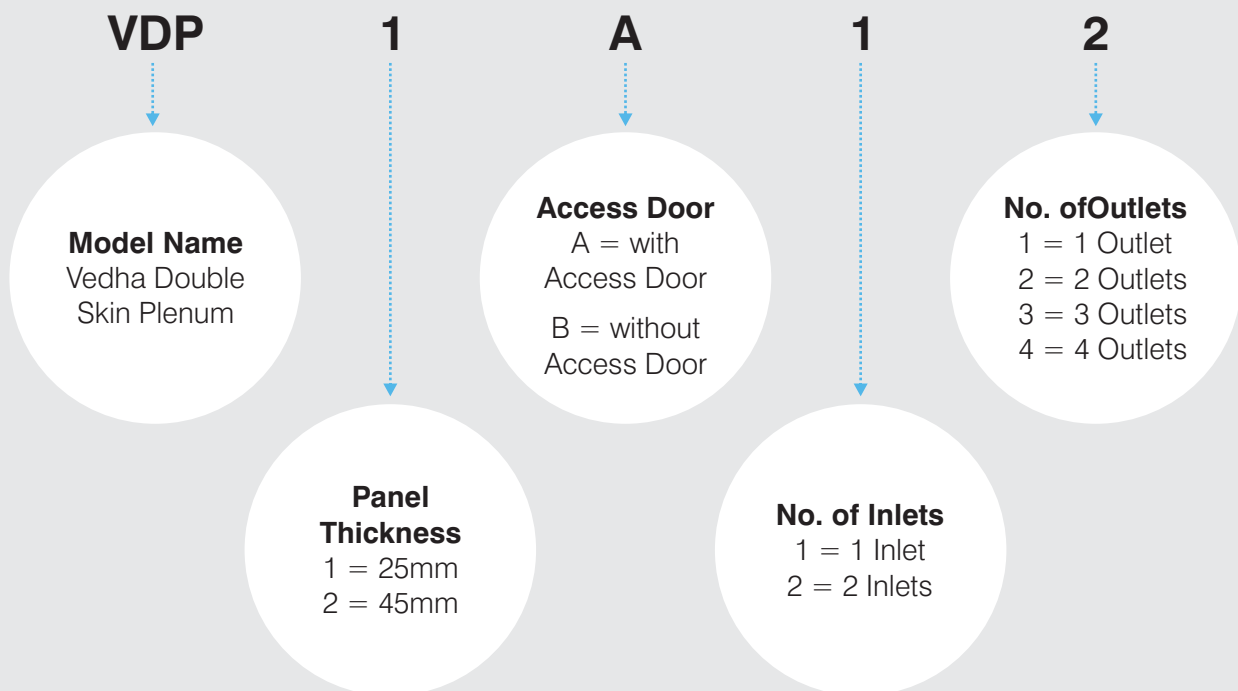

EXAMPLE:

VDP-2-B-1-3 - VEDHA Double Skin Plenum with 45mm panel, without access door, 1 inlet and 3 outlets.

NOTE: * For non-standard plenum requirement, nomenclature may vary and subject to manufacturing feasibility.



Expertise to rely on

VEDHA ENTECH INDIA PVT. LTD.

Survey No. 404 - 2, Puttaparthi Road, Kodur village
Chilamathur Mandal, Anantapuramu District, AP, India - 515601

Email: info@vedhaentech.in | www.vedhaentech.in